

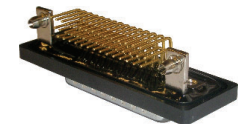

Contents

Waterproof D-Sub Connectors

Standard Shell Assembly _____	page 3
Male Shell	3
Female Shell	3
Watertight Frame _____	page 4
Standard Frame	4
Waterproof Standard Density _____	page 5
Data / Layout	5
P/N Code	6
R/A pcb solder layout	7
Straight pcb solder layout	7
Waterproof High Density _____	page 8
Data / Layout	8
P/N Code	9
R/A pcb solder layout	10
Straight pcb solder layout	10
Waterproof Power _____	page 11
Data / Layout	11
P/N Code	12
R/A power contacts	13
R/A pcb solder layout	14
Straight contacts	15
Straight pcb solder layout	16
Solder cup contacts	17

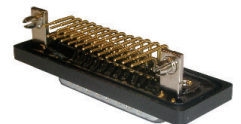

**Specification is subject to change, please consult factory for latest drawings.*

D-Sub Standard Shell Assembly

MALE SHELL

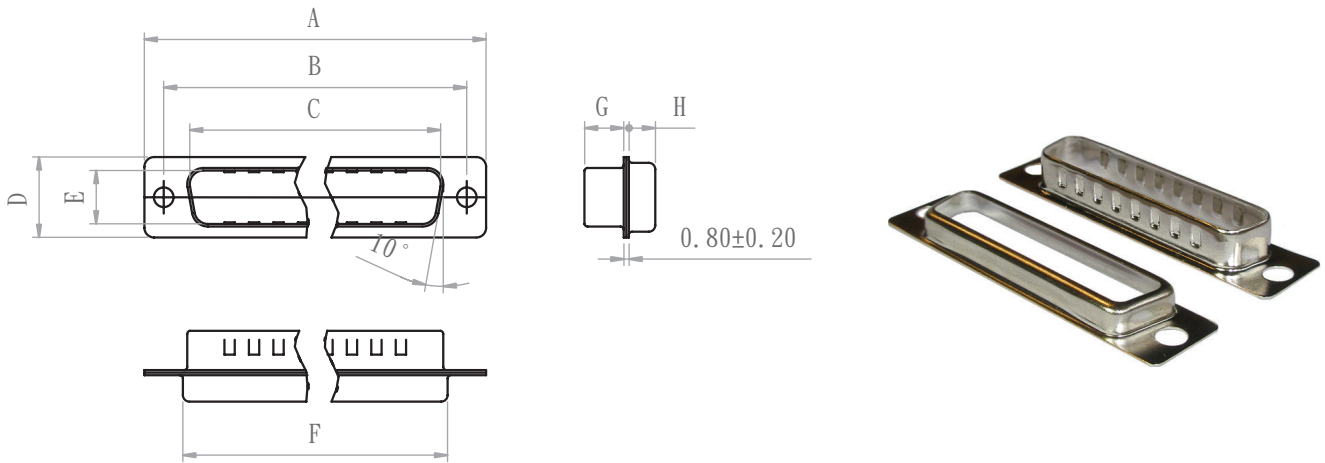

SHELL SIZE	A±0.20mm	B±0.15mm	C±0.20mm	D±0.20mm	E±0.20mm	F±0.20mm	G±0.20mm	H±0.15mm
1(E)	30.8	25	16.9	12.5	8.3	19.25	6.1	4.1
2(A)	39.2	33.3	25.25	12.5	8.3	27.7	6.1	4.1
3(B)	53.05	47.05	38.95	12.5	8.3	41.2	6.1	4.1
4(C)	69.4	63.5	55.4	12.5	8.3	57.5	6.1	4.1

FEMALE SHELL

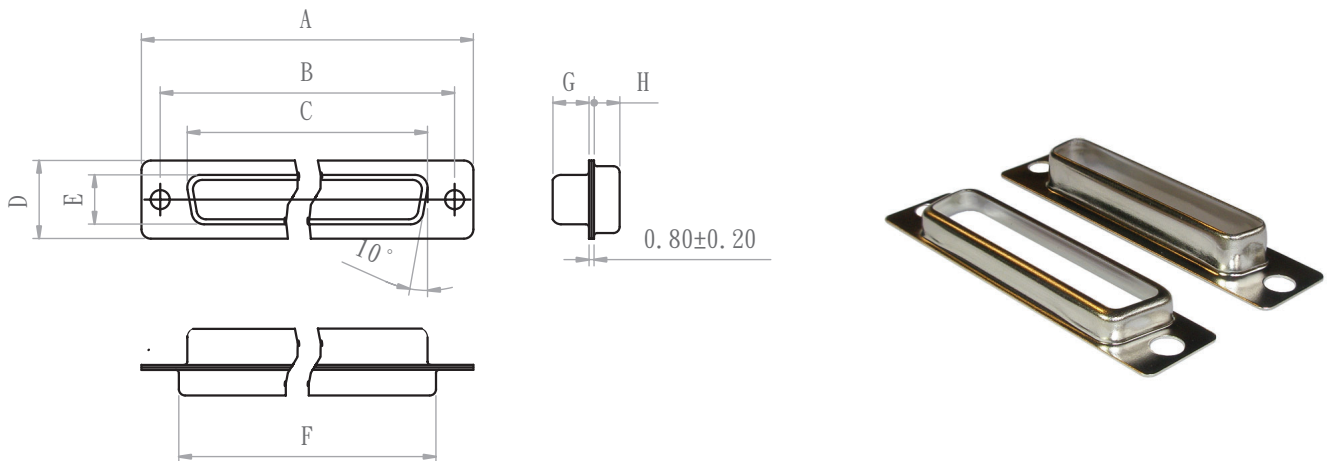

SHELL SIZE	A±0.20mm	B±0.15mm	C±0.20mm	D±0.20mm	E±0.20mm	F±0.20mm	G±0.20mm	H±0.15mm
1(E)	30.8	25	16.3	12.5	7.9	19.25	5.8	4.1
2(A)	39.2	33.3	24.6	12.5	7.9	27.7	5.8	4.1
3(B)	53.05	47.05	38.4	12.5	7.9	41.2	5.8	4.1
4(C)	69.4	63.5	54.8	12.5	7.9	57.5	5.8	4.1

Waterproof (IP67) Frame

STANDARD FRAME

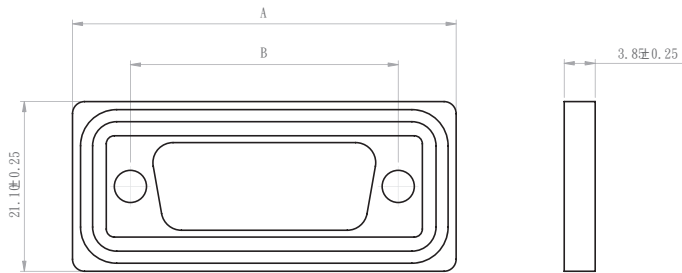

SHELL SIZE	A±0.25mm	B±0.25mm
1(E)	39.2	24.8
2(A)	47.7	33.3
3(B)	61.2	46.8
4(C)	77.5	63.1

Waterproof D-Sub Standard Density

Data

Materials and finish

Shell: Steel with Nickel plating

Insulator: PBT 30% GF, UL 94V-0, black color

Watertight frame: PBT GF, UL 94V-0 , black color

O-Ring: Silicone

Sealing compound: Epoxy

Contact material: Copper alloy, Gold plated

Electrical characteristics

Contact current rating: 5.0 A

Contact resistance: 10 mΩ max.

Dielectric withstanding voltage: 1000 V DC (for 1 minute)

Insulation resistance: 5000 MΩ min.

Temperature rating: -25°C ~ +85°C

Degree of protection: IP67 according to IEC60529

R/A PCB SOLDER

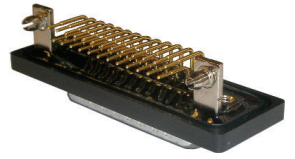

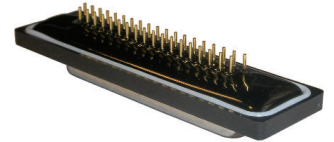

STRAIGHT PCB SOLDER



SOLDER CUP

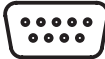
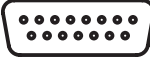
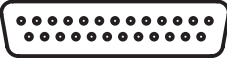

Layout

SHELL SIZE	CONTACTS	LAYOUT
1(E)	9	
2(A)	15	
3(B)	25	
4(C)	37	

Waterproof D-Sub Standard Density

Part Number Code

WD S 0 09 M9 CN B O

Series:

WD = Waterproof (IP67)
D-Sub Standard Density

Contact termination:

S = Solder cup
T = Straight pcb solder
R = R/A pcb solder

Signal contact plating:

0 = Gold flash over Nickel (Economy)
2 = 5 μ " Gold over Nickel
1 = 15 μ " Gold over Nickel
3 = 30 μ " Gold over Nickel

Number of contacts:

09 = 9 **15** = 15 **25** = 25 **37** = 37

Contact type:

M9 = Male **F9** = Female

Shell plating

CN = Nickel plated

Edition

If standard leave blank.

Mounting:

O = Mounting threads
S6 = Boardlock on back shell

Bracket (only for R/A)

1 = Bracket with boardlock
1N = Bracket w/o boardlock

Mounting thread option:

for UNC #4-40, leave blank

M=M3

Insulator color:

B = Black

Mounting illustrations

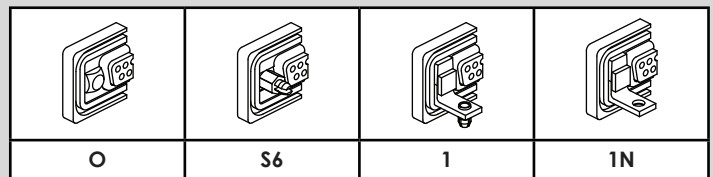

Waterproof D-Sub Standard Density

R/A pcb solder layout

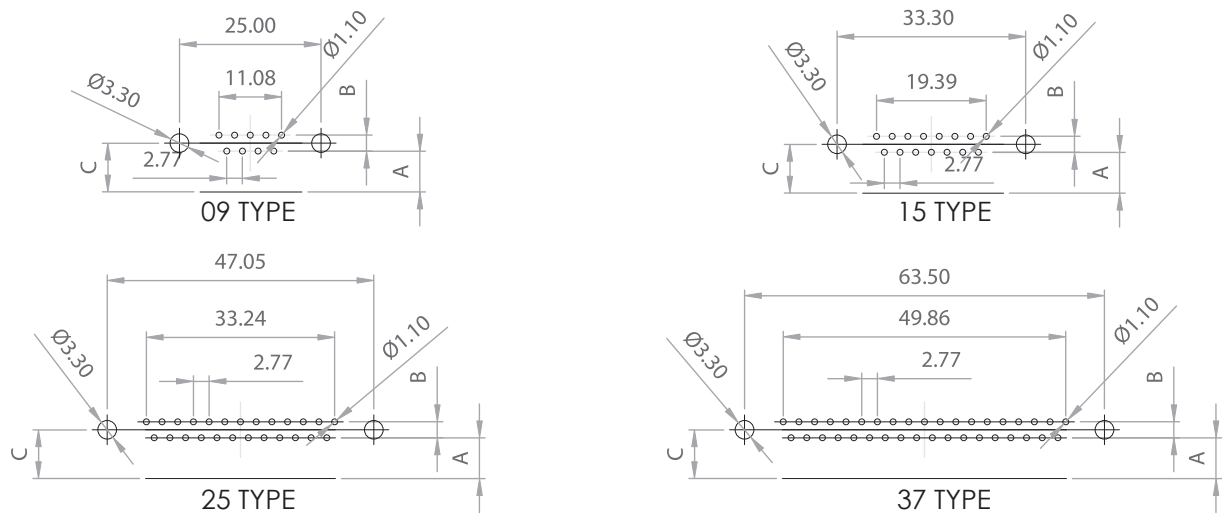

Dimension (mm)	
A	6.45
B	2.54
C	8.12

Straight pcb solder layout

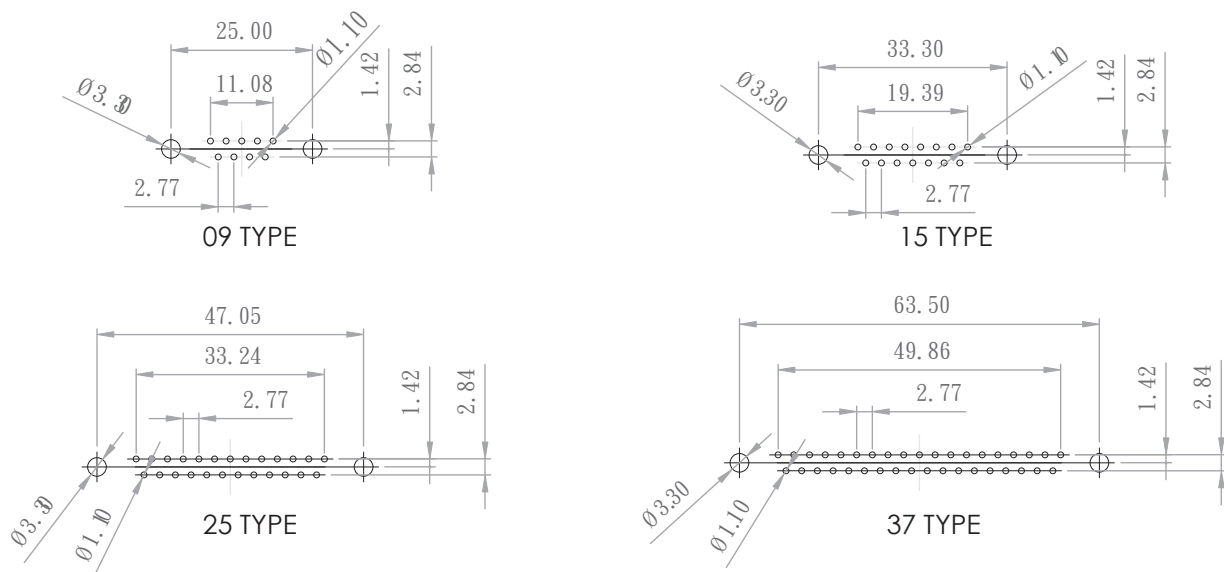

Waterproof D-Sub High Density

Data

Materials and finish

Shell: Steel with Nickel plating

Insulator: PBT 30% GF, UL 94V-0, black color

Watertight frame: PBT GF, UL 94V-0, black color

O-Ring: Silicone

Sealing compound: Epoxy

Contact material: Copper alloy, Gold plated

Electrical characteristics

Contact current rating: 3.0 A

Contact resistance: 10 mΩ max.

Dielectric withstanding voltage: 1000 V AC (for 1 minute)

Insulation resistance: 5000 MΩ min.

Temperature rating: -25°C ~ +85°C

Degree of protection: IP67 according to IEC60529

R/A PCB SOLDER

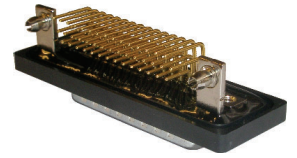

STRAIGHT PCB SOLDER

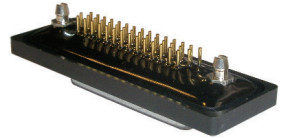

SOLDER CUP

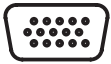
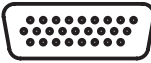
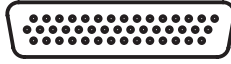
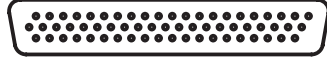

Layout

SHELL SIZE	CONTACTS	LAYOUT
1(E)	15	
2(A)	26	
3(B)	44	
4(C)	62	

Waterproof D-Sub High Density

Part Number Code

WH S 0 15 M9 CN B O

Series:

WH = Waterproof (IP67)
D-Sub High Density

Contact termination:

S = Solder cup
T = Straight pcb solder
R = R/A pcb solder

Signal contact plating:

0 = Gold flash over Nickel (Economy)
2 = 5 μ " Gold over Nickel
1 = 15 μ " Gold over Nickel
3 = 30 μ " Gold over Nickel

Number of contacts:

15 = 15 **26** = 26 **44** = 44 **62** = 62

Contact type:

M9 = Male **F9** = Female

Shell plating

CN = Nickel plated

Edition

If standard leave blank.

Mounting:

O = Mounting hole
S6 = Boardlock on back shell

Bracket (only for R/A)

1 = Bracket with boardlock
1N = Bracket w/o boardlock

Mounting thread option:

for UNC #4-40, leave blank

M=M3

Insulator color:

B = Black

Mounting illustrations

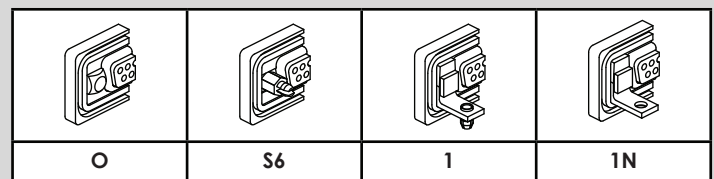

Waterproof D-Sub High Density

R/A pcb layout

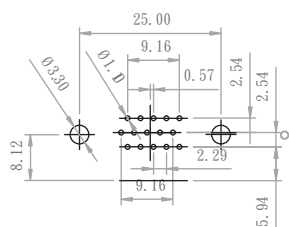

15 TYPE

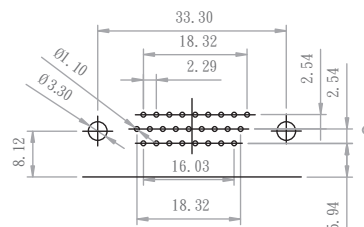

26 TYPE

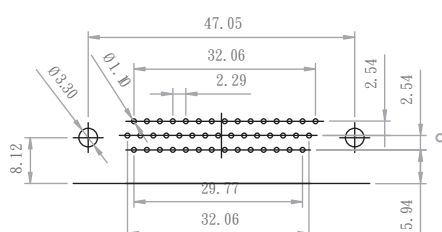

44 TYPE

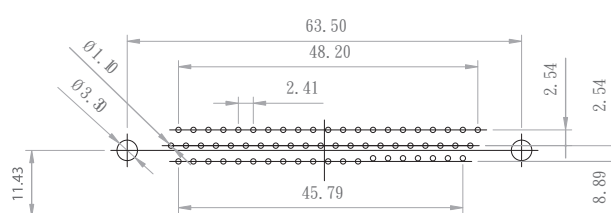

62 TYPE

Straight pcb solder layout

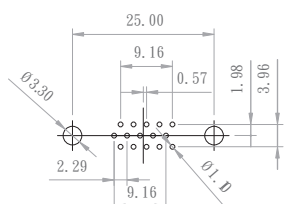

15 TYPE

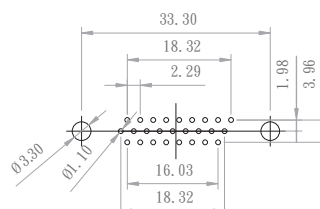

26 TYPE

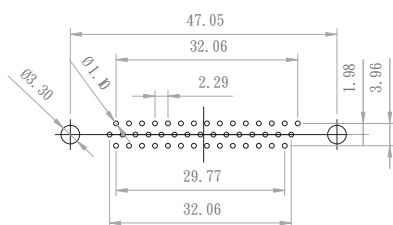

44 TYPE

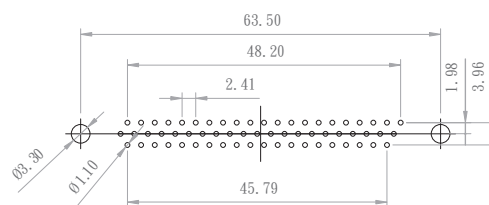

62 TYPE

Waterproof D-Sub Power Combo

Data

Materials and finish

Shell: Steel with Nickel plating

Insulator: PBT 30% GF, UL 94V-0, black color

Watertight frame: PBT GF, UL 94V-0, black color

O-Ring: Silicone

Sealing compound: Epoxy

Contact material: Copper alloy, Gold plated

Electrical characteristics

High power contact current rating: 10A - 40A

High power contact resistance: 1.0 mΩ max.

Signal contact current rating: 5.0 A

Signal contact resistance: 10 mΩ max.

Dielectric withstanding voltage: 1000 V AC (for 1 minute)

Insulation resistance: 5000 MΩ min.

Temperature rating: -25°C ~ +85°C

Degree of protection: IP67 according to IEC60529

R/A PCB SOLDER





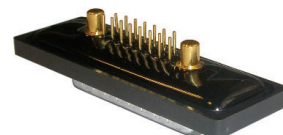









STRAIGHT PCB SOLDER



SOLDER CUP

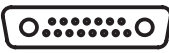

Layout

SHELL SIZE	LAYOUT			
1(E)	 2WK2(MALE)	 2WK2(FEMALE)	 2W2	 5W1
2(A)	 3WK3(FEMALE)	 3WK3(MALE)	 3W3	 7W2
3(B)	 5W5	 9W4	 13W3	
		 17W2	 21W1	

Waterproof D-Sub Power Combo

Power Connector Part Number Code

WP S 40 0 0 7W2 M9 CN B O

Series:

WP = Waterproof (IP67)
D-Sub Power Combo

Contact termination:

S = Solder cup
T = Straight pcb solder
R = R/A pcb solder

Performance:

10=10A **20**=20A
30=30A **40**=40A

Power contact plating:

0 = Gold flash over Nickel (Economy)
2 = 5 μ " Gold over Nickel
1 = 15 μ " Gold over Nickel
3 = 30 μ " Gold over Nickel

Signal contact plating:

0 = Gold flash over Nickel (Economy)
2 = 5 μ " Gold over Nickel
1 = 15 μ " Gold over Nickel
3 = 30 μ " Gold over Nickel
N = Without signal contact

Layout:

2W2, 2WK2, 5W1, 3W3, 3WK3, 7W2, 11W1,
5W5, 9W4, 13W3, 17W2, 21W1,

Edition

If standard leave blank.

Mounting:

O = Mounting threads
S6 = Boardlock on back shell

Bracket (only for R/A)

1 = Bracket with boardlock
1N = Bracket w/o boardlock

Mounting thread option:

for UNC #4-40, leave blank

M=M3 (also for no threads, blank)

Insulator color:

B = Black

Shell plating

CN = Nickel plated

Contact type:

M9 = Male **F9** = Female

Mounting illustrations

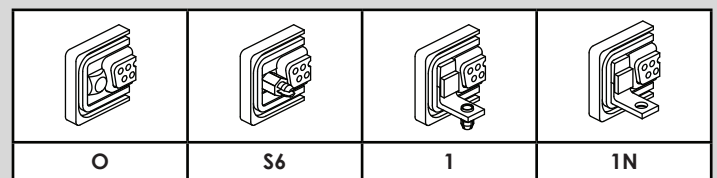

Waterproof D-Sub Power Combo

R/A pcb solder power contacts

MALE

FEMALE

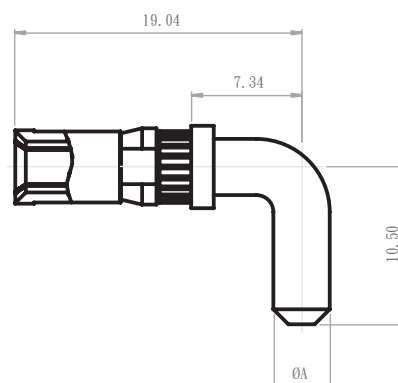
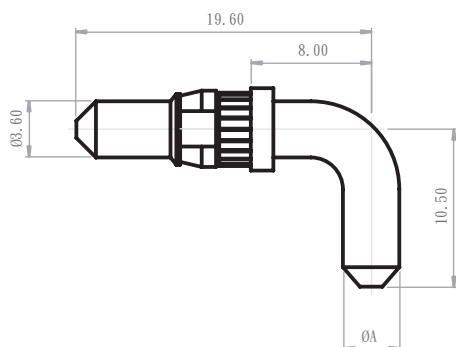

Current Rating	Dimension (mm) ØA
10A	1.7
20A	2.8
30A	3.2
40A	3.75

Waterproof D-Sub Power Combo

R/A pcb solder layout

Shell size 1 (E)

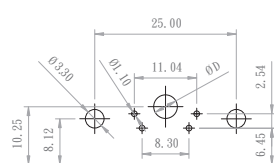

5W1

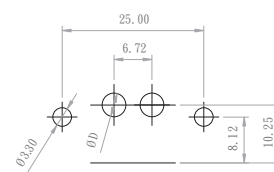

2W2/2WK2

Shell size 2 (A)

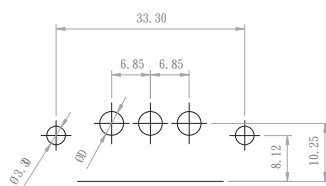

3W3/3WK3

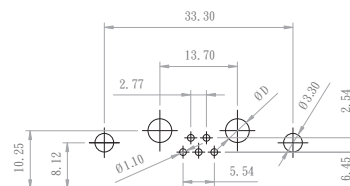

7W2

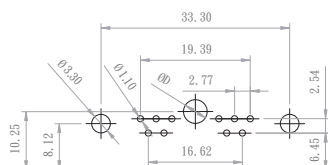

11W1

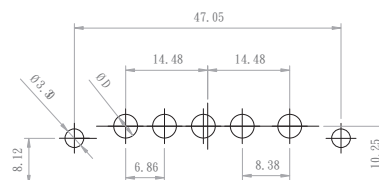

5W5

Shell size 3 (B)

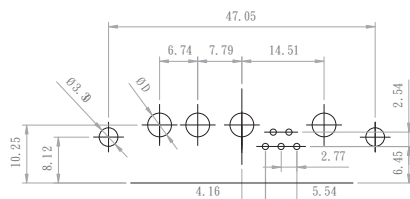

9W4

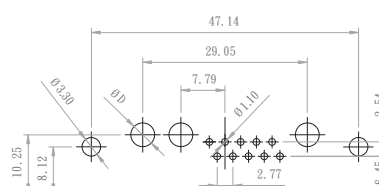

13W3

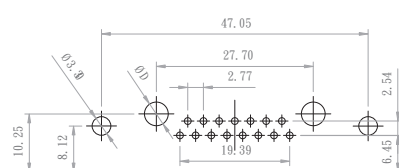

17W2

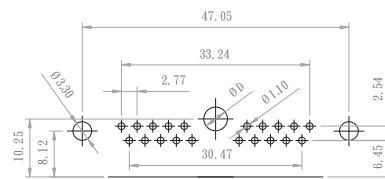

21W1

Current Rating	10A	20A	30A	40A
D	2.2	3.3	3.7	4.2

Waterproof D-Sub Power Combo

Straight pcb solder power contacts

MALE

FEMALE

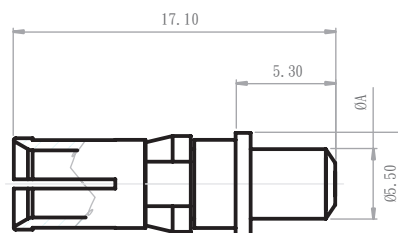
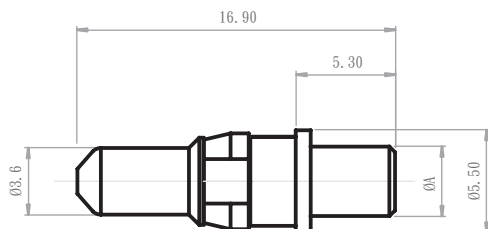

Current Rating	Dimension (mm) ØA
10A	1.7
20A	2.8
30A	3.2
40A	3.75

Waterproof D-Sub Power Combo

Straight pcb solder layout

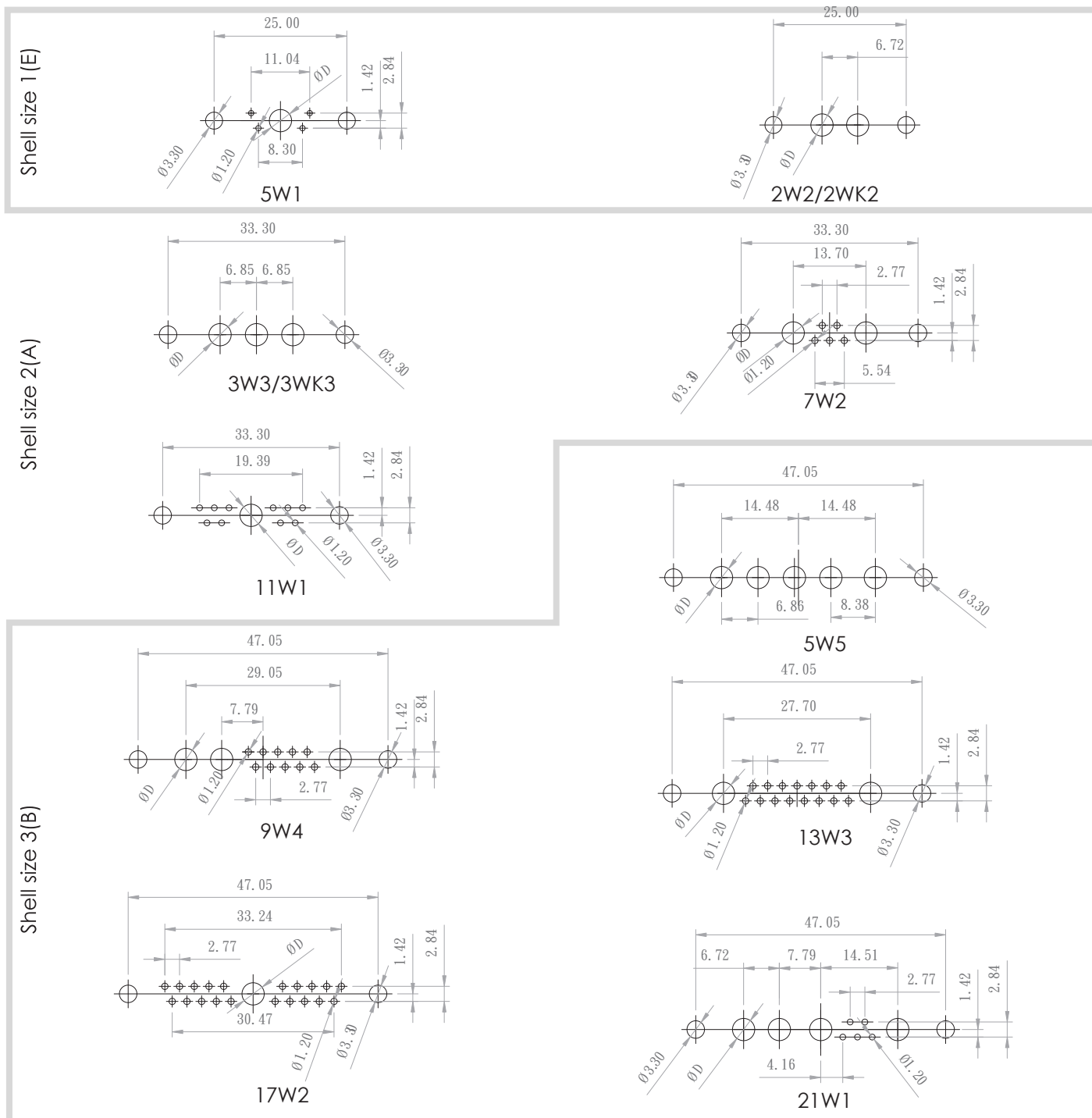

Current Rating	10A	20A	30A	40A
D	2.2	3.3	3.7	4.2

Waterproof D-Sub Power Combo

Solder cup power contacts

FEMALE

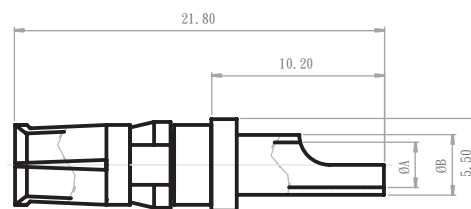
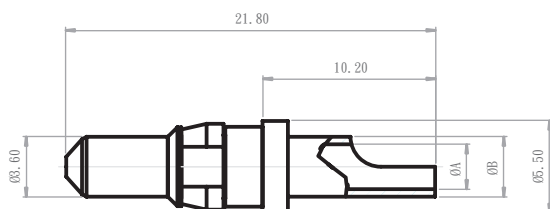

Current Rating	Dimension (mm) ØA	Dimension (mm) ØB
10A	1.7	2.5
20A	2.7	3.6
30A	3.5	4.4
40A	4.6	5.5

KONMEK

No. 8, Alley 25, Lane 126,
Sec. 3, Jhongyang Rd.,
Tucheng District,
New Taipei City 23673
Taiwan

Telephone
886-2-2267-1002

E-mail
service@konmek.com

Telefax
886-2-2268-9774

URL
www.konmek.com