

Power D-Sub

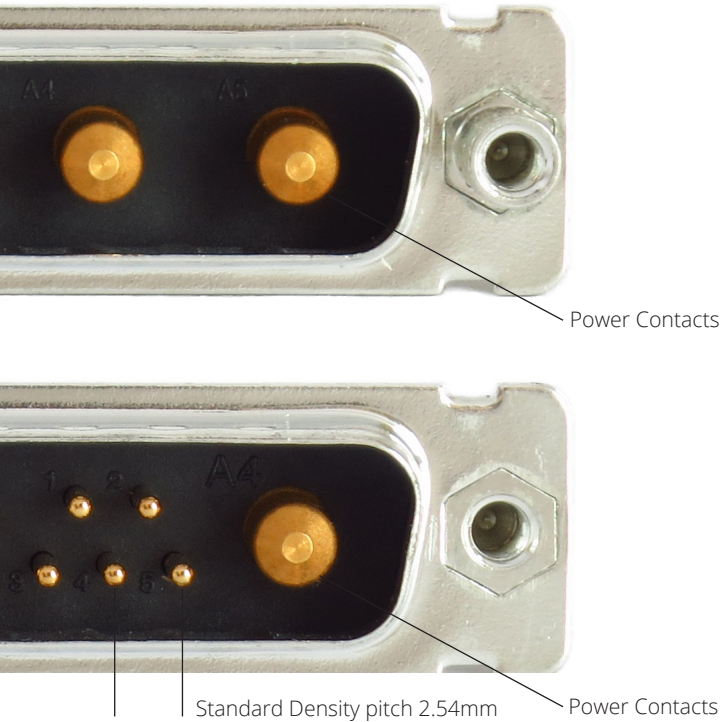

Power D-Sub Full Layout

The Power D-Sub have replaced the two rows in a Standard Density connector with a power contact that take up about the same size as the two rows of signal contacts. The Power D-Sub is exactly the same size as the Standard Density connector but instead of example 9 positions of signal pins it has 2 power contacts , or instead of 37 positions of signals it has 8 power.

KP

Power D-Sub Mixed Layout

The Power D-Sub with Mixed Layout is a very popular connector and that it is for a reason, as the name apply, the connector mixes both power contacts and signal contacts in the same connector. For example the same size as a 15 position Standard Density D-Sub you can have what we call a 7W2, which means there is 7 contacts where 2 of them are power contacts, which means there are 5 signal contacts, so 5 signals and 2 power. See the Layout in the Tech Specs on the bottom, there are a lot of combinations of the Mixed Layout alternative.

Tech Spec

	Full Layout	Mixed Layout
Material Data		
Insulator	Polyester GF UL94V-0	
Insulator color	●	●
Contacts	Precision machined copper alloy	
Contact plating	Hard Gold plated over Nickel	
Shell	Steel, dimples on Male shell	
Shell plating	Tin plated over Nickel or Nickel plating	
Electrical Data		
Working Voltage	125 V	
Dielectric strenght / Test Voltage	Contact - contact 1000 V r.m.s.	
Power contact current rating	10 A, 20 A, 30 A and 40 A	
Power contact resistance	< 1mΩ	
Signal contact current rating	-	5.0 A
Signal contact resistance	-	< 10mΩ
Insulation resistance	>5GΩ	
Mechanical Data		
Creepage distance signal contacts	-	1.0mm
Operating Temperature	Temp -55°C to +125°C	
Quality Class	Quality Class 1 = 500 Mating Cycles, 30μ" (0.8μm) Gold over Nickel) Quality Class 3 = 50 Mating Cycles 8μ" (0.2μm) Gold over Nickel For other plating alternatives contact factory	

Power D-Sub

Layout

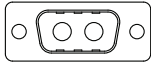
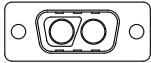
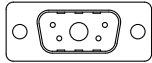
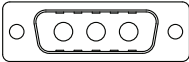
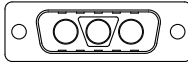
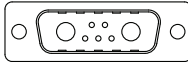
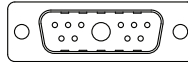
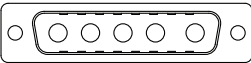
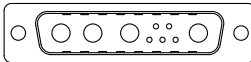
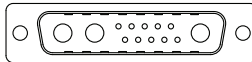
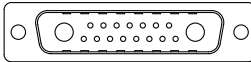
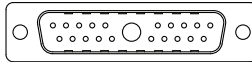
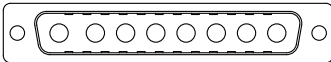
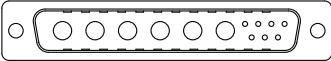
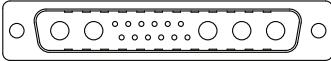
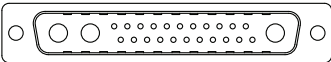
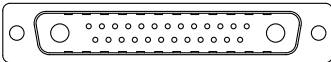
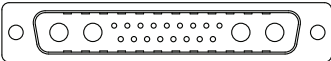
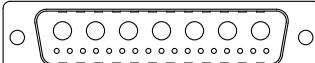
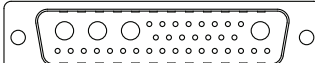
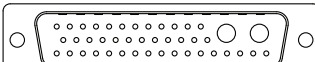
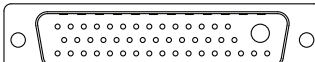
	Full Layout	Mixed Layout
Size 1(E)	 2W2  2WK2	 5W1
Size 2(A)	 3W3  3WK3	 7W2  11W1
Size 3(B)	 5W5	 9W4  13W3  17W2  21W1
Size 4(C)	 8W8	 13W6  17W5  25W3  27W2  21W4
Size 5(D)		 24W7  36W4  43W2  47W1

KP

Power D-Sub Full Layout KP Series

Solder cup

Male

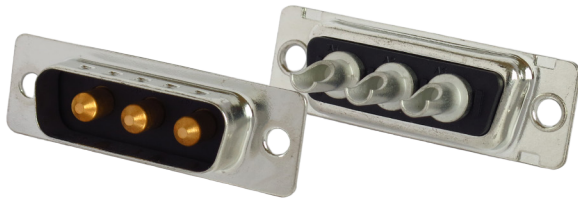

Female



KP

Drawing

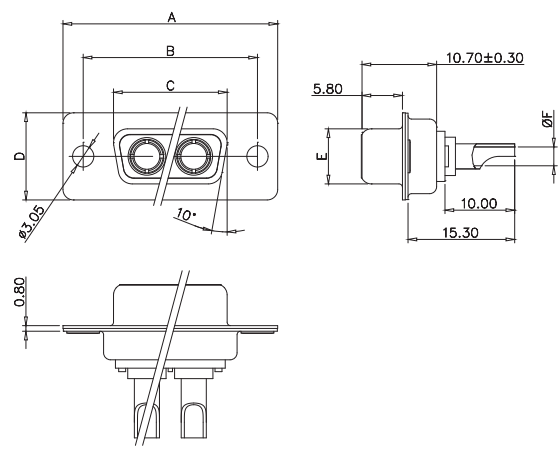
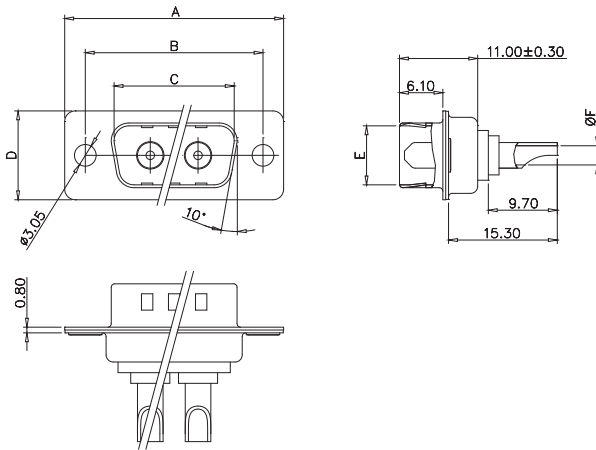

Size	A	B	C	D	E	Rating	Ø F
1(E)	30.80	25.00	16.90	12.50	8.30	10A	1.7
2(A)	39.20	33.30	25.25	12.50	8.30	20A	2.7
3(B)	53.05	47.05	38.95	12.50	8.30	30A	3.5
4(C)	69.40	63.50	55.40	12.50	8.30	40A	4.6

Size	A	B	C	D	E	Rating	Ø F
1(E)	30.80	25.00	16.30	12.50	7.90	10A	1.7
2(A)	39.20	33.30	24.60	12.50	7.90	20A	2.7
3(B)	53.05	47.05	38.40	12.50	7.90	30A	3.5
4(C)	69.40	63.50	54.80	12.50	7.90	40A	4.6

Part Number Code

Series: KP S 2 4 -3W3 M T B
 KP = Power D-Sub

Terminal type:
 S = Solder cup

Current rating:
 1 = 10A 2 = 20A 3 = 30A 4 = 40A

Contact plating*:
 4 = Quality Class 3 (standard)
 3 = Quality Class 1

Layout:
 2W2 2WK2 3W3 3WK3 5W5 8W8

A1 Mounting*:
 A1 = Mounting hole
 B1 = B1 with 4-40 UNC
 B6 = B6 with M3
 See mounting drawings below for more details

Insulator color:
 B = Black

Shell plating*:
 T = Tin (standard) N = Nickel

Gender:
 M = Male F = Female

*Contact sales for more details, Konmek have a wide range of alternatives available.

Power D-Sub Full Layout KP Series

Solder cup
Mounting

A1

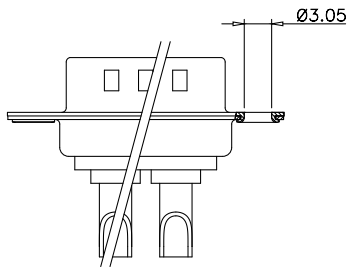

B1/B6

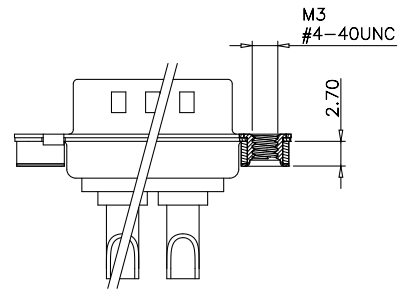

KP

Power D-Sub Full Layout KP Series

Straight PCB solder

Male

Female



KP

Drawing

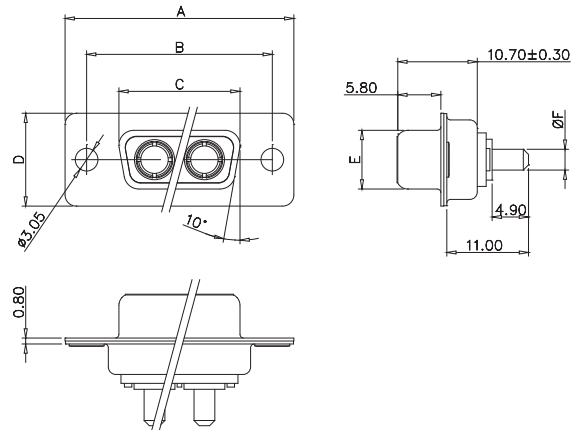
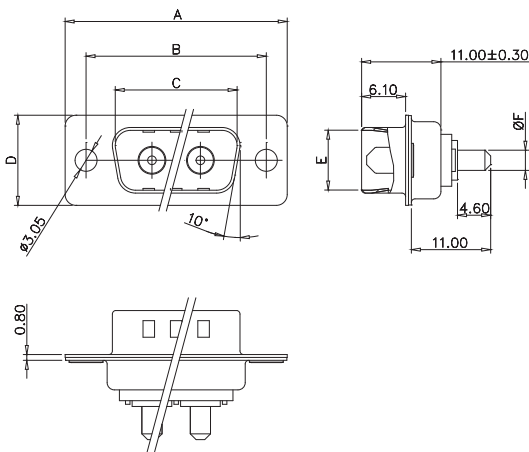

Size	A	B	C	D	E	Rating	Ø F
1(E)	30.80	25.00	16.90	12.50	8.30	10A	1.7
2(A)	39.20	33.30	25.25	12.50	8.30	20A	2.8
3(B)	53.05	47.05	38.95	12.50	8.30	30A	3.2
4(C)	69.40	63.50	55.40	12.50	8.30	40A	3.75

Size	A	B	C	D	E	Rating	Ø F
1(E)	30.80	25.00	16.30	12.50	7.90	10A	1.7
2(A)	39.20	33.30	24.60	12.50	7.90	20A	2.8
3(B)	53.05	47.05	38.40	12.50	7.90	30A	3.2
4(C)	69.40	63.50	54.80	12.50	7.90	40A	3.75

Part Number Code

Series: KP T 2 4 -3W3 M T B

KP = Power D-Sub

Terminal type:
T = Straight PCB solder

Current rating:
1 = 10A 2 = 20A 3 = 30A 4 = 40A

Contact plating*:
4 = Quality Class 3 (standard)
3 = Quality Class 1

Layout:
2W2 2WK2 3W3 3WK3 5W5 8W8

C1 Mounting*:
 A1 = A1 No threads B8 = B8 with M3
 B1 = B1 with 4-40 UNC C1 = C1 with 4-40 UNC
 B2 = B2 with 4-40 UNC C2 = C2 with 4-40 UNC
 B3 = B3 with 4-40 UNC C6 = C6 with M3
 B6 = B6 with M3 C7 = C7 with M3
 B7 = B7 with M3
 See mounting drawings below for more details

Insulator color:
B = Black

Shell plating*:
T = Tin (standard) N = Nickel

Gender:
M = Male F = Female

*Contact sales for more details, Konmek have a wide range of alternatives available.

Power D-Sub Full Layout KP Series

Straight PCB solder
Mounting

A1

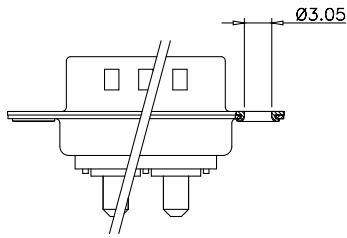

B1/B6

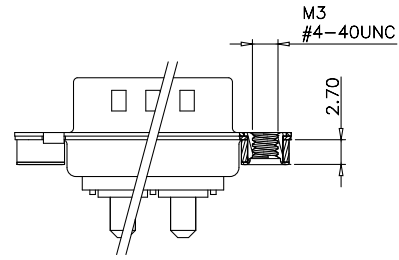

B2/B7

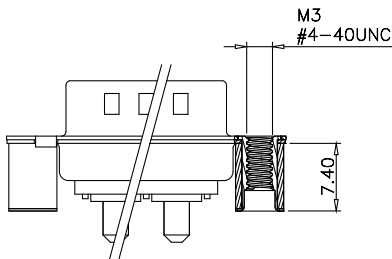

B3/B8

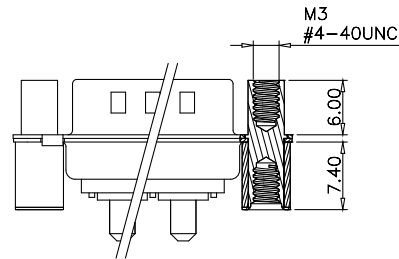

C1/C6

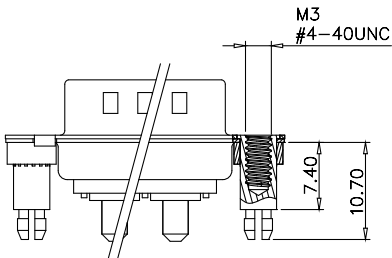

C2/C7

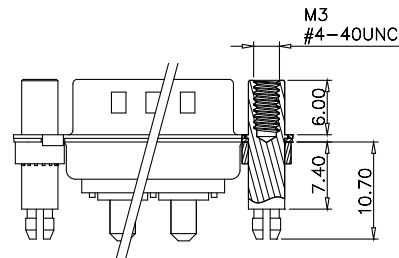

KP

Power D-Sub Full Layout KP Series

Straight PCB solder

PCB Layout for Male and Female connector

2W2 / 2WK2

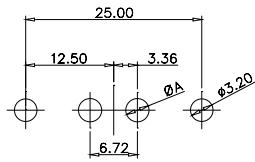

3W3 / 3WK3

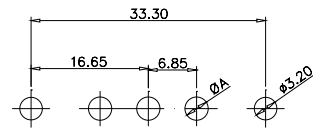

5W5 Male

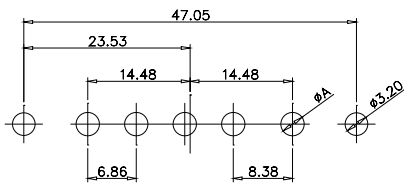

8W8 Male

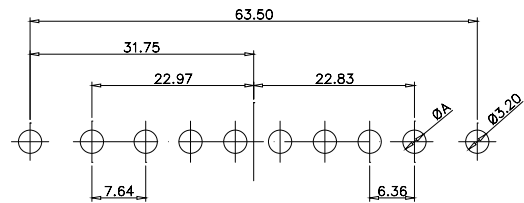

5W5 Female

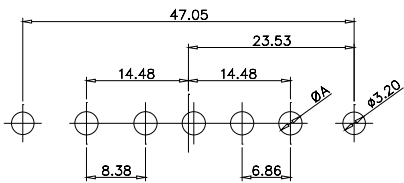

8W8 Female

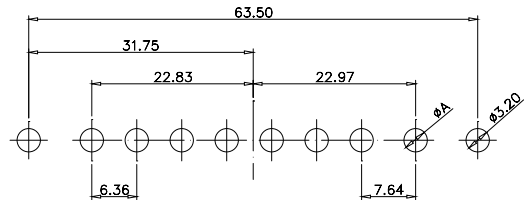

Current Rating	10A	20A	30A	40A
Ø A (mm)	2.2	3.3	3.7	4.2

Power D-Sub Full Layout KP Series

R/A PCB solder

Male



Female

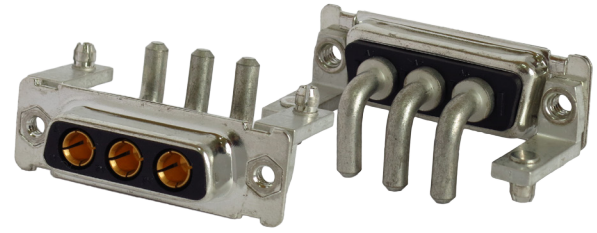

KP

Drawing

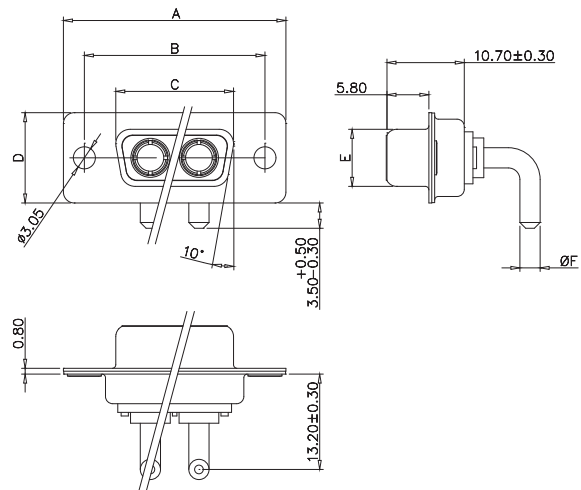
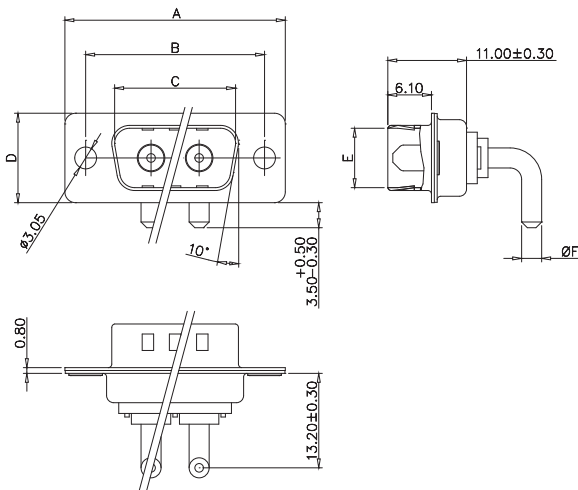

Size	A	B	C	D	E	Rating	Ø F
1(E)	30.80	25.00	16.90	12.50	8.30	10A	1.7
2(A)	39.20	33.30	25.25	12.50	8.30	20A	2.8
3(B)	53.05	47.05	38.95	12.50	8.30	30A	3.2
4(C)	69.40	63.50	55.40	12.50	8.30	40A	3.75

Size	A	B	C	D	E	Rating	Ø F
1(E)	30.80	25.00	16.30	12.50	7.90	10A	1.7
2(A)	39.20	33.30	24.60	12.50	7.90	20A	2.8
3(B)	53.05	47.05	38.40	12.50	7.90	30A	3.2
4(C)	69.40	63.50	54.80	12.50	7.90	40A	3.75

Part Number Code

Series: KP R 2 4 -3W3 M T B

KP = Power D-Sub

Terminal type: R = R/A PCB solder

Current rating: 1 = 10A 2 = 20A 3 = 30A 4 = 40A

Contact plating*: 4 = Quality Class 3 (standard) 3 = Quality Class 1

Layout: 2W2 2WK2 3W3 3WK3 5W5 8W8

D1 Mounting*:

A1 = A1 No threads	D4 = D4 with 4-40 UNC
B1 = B1 with 4-40 UNC	D6 = D6 with M3
B6 = B6 with M3	D7 = D7 with M3
D1 = D1 with 4-40 UNC	D8 = D8 with M3
D2 = D2 with 4-40 UNC	D9 = D9 with M3
D3 = D3 with 4-40 UNC	

See mounting drawings below for more details

Insulator color: B = Black

Shell plating*: T = Tin (standard) N = Nickel

Gender: M = Male F = Female

*Contact sales for more details, Konmek have a wide range of alternatives available.

Power D-Sub Full Layout KP Series

R/A PCB solder
Mounting

A1

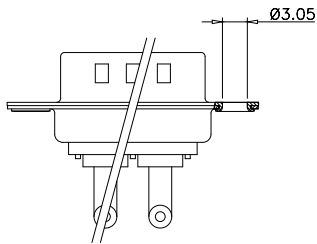

B1/B6

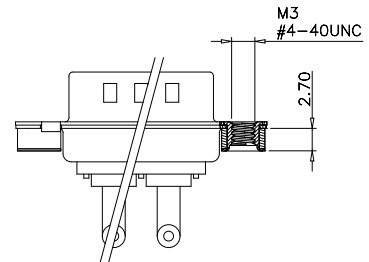

D1/D6

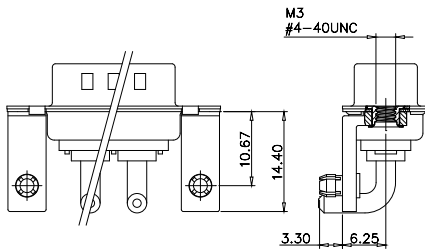

D2/D7

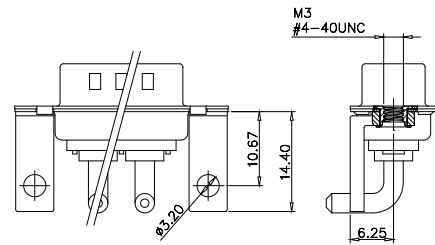

D3/D8

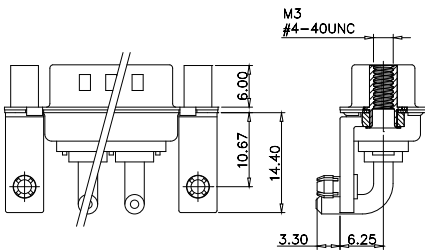

D4/D9

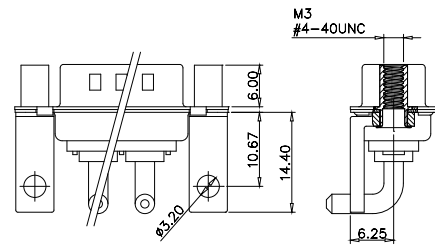

KP

Power D-Sub Full Layout KP Series

R/A PCB solder

PCB Layout

2W2 / 2WK2

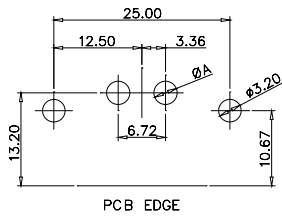

3W3 / 3WK3

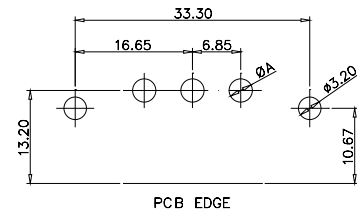

5W5 Male

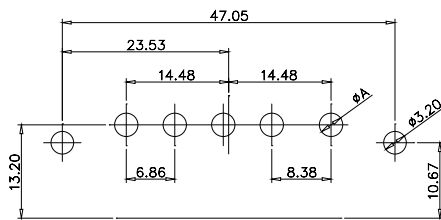

8W8 Male

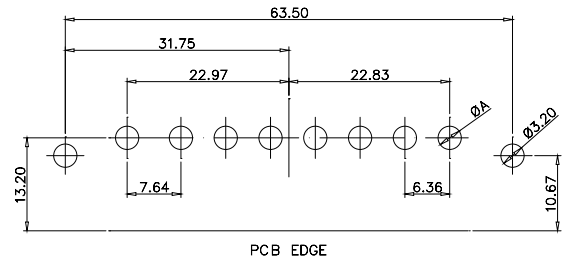

5W5 Female

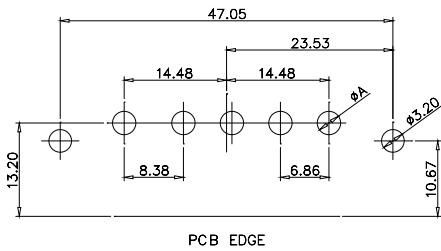

8W8 Female

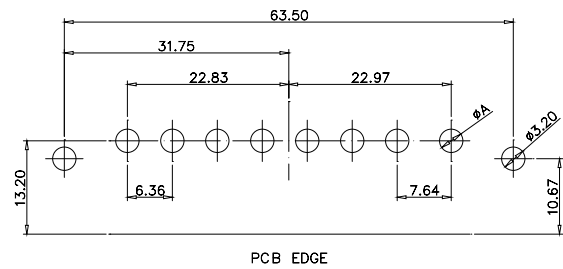

Current Rating	10A	20A	30A	40A
Ø A (mm)	2.2	3.3	3.7	4.2

Power D-Sub Mixed Layout KP Series

Solder cup

Male



Female



KP

Drawing

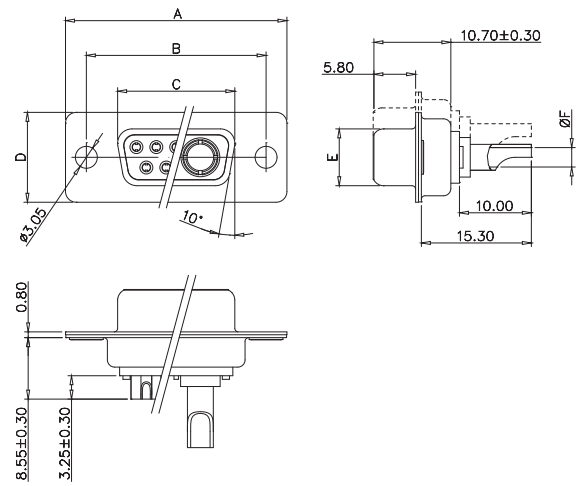
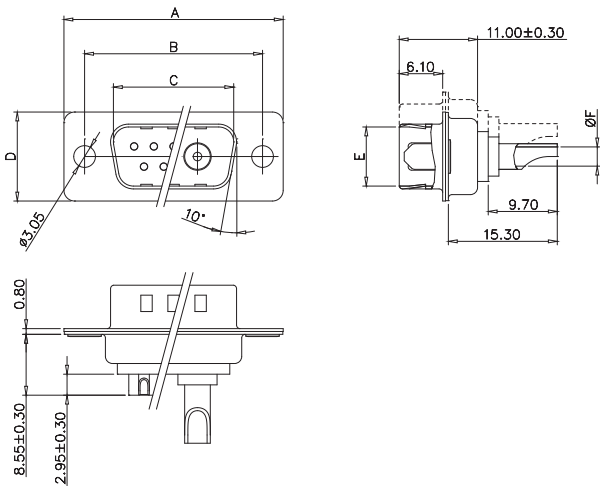

Size	A	B	C	D	E	Rating	Ø F
1(E)	30.80	25.00	16.90	12.50	8.30	10A	1.7
2(A)	39.20	33.30	25.25	12.50	8.30	20A	2.7
3(B)	53.05	47.05	38.95	12.50	8.30	30A	3.5
4(C)	69.40	63.50	55.40	12.50	8.30	40A	4.6
5(D)	67.00	61.00	52.80	15.30	11.15		

Size	A	B	C	D	E	Rating	Ø F
1(E)	30.80	25.00	16.30	12.50	7.90	10A	1.7
2(A)	39.20	33.30	24.60	12.50	7.90	20A	2.7
3(B)	53.05	47.05	38.40	12.50	7.90	30A	3.5
4(C)	69.40	63.50	54.80	12.50	7.90	40A	4.6
5(D)	67.00	61.00	52.20	15.30	10.90		

Part Number Code

Series: KP S 2 4 -7W2 M T B

KP = Power D-Sub

Terminal type:

S = Solder cup

Current rating:

1 = 10A 2 = 20A 3 = 30A 4 = 40A

Contact plating*:

4 = Quality Class 3 (standard)

3 = Quality Class 1

Layout:

5W1 7W2 11W1 9W4 13W3 17W2 21W1
13W6 17W5 25W3 27W2 21W4 25W3 27W2
21W4 24W7 36W4 43W2 47W1

A1 Mounting*:

A1 = Mounting hole

B1 = B1 with 4-40 UNC

B6 = B6 with M3

See mounting drawings below for more details

Insulator color:

B = Black

Shell plating*:

T = Tin (standard)

N = Nickel

Gender:

M = Male F = Female

*Contact sales for more details, Konmek have a wide range of alternatives available.

Power D-Sub Mixed Layout KP Series

Solder cup
Mounting

A1

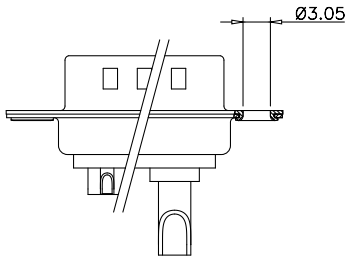

B1/B6

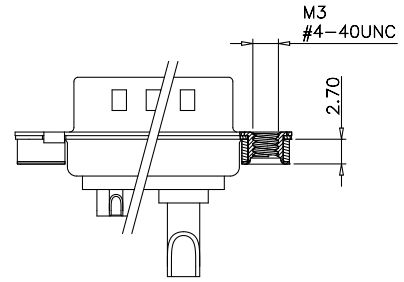

KP

Power D-Sub Mixed Layout KP Series

Straight PCB solder

Male

Female



KP

Drawing

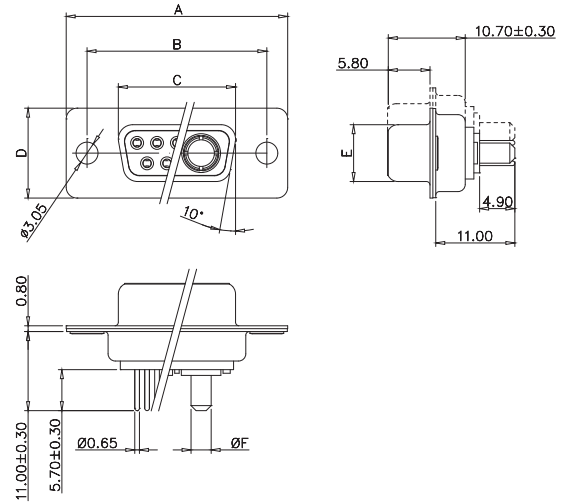
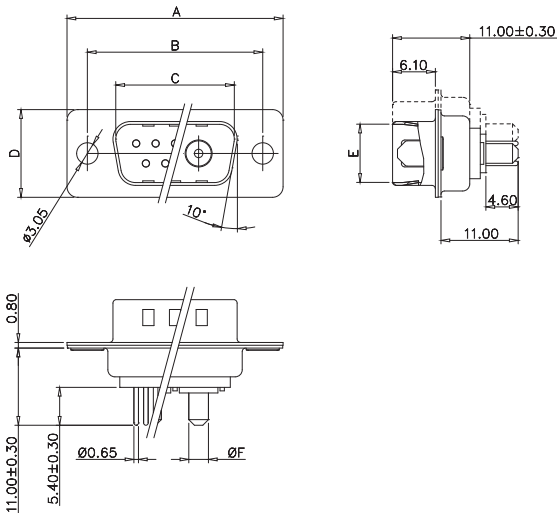

Size	A	B	C	D	E	Rating	Ø F
1(E)	30.80	25.00	16.90	12.50	8.30	10A	1.7
2(A)	39.20	33.30	25.25	12.50	8.30	20A	2.8
3(B)	53.05	47.05	38.95	12.50	8.30	30A	3.2
4(C)	69.40	63.50	55.40	12.50	8.30	40A	3.75
5(D)	67.00	61.00	52.80	15.30	11.15		

Size	A	B	C	D	E	Rating	Ø F
1(E)	30.80	25.00	16.30	12.50	7.90	10A	1.7
2(A)	39.20	33.30	24.60	12.50	7.90	20A	2.8
3(B)	53.05	47.05	38.40	12.50	7.90	30A	3.2
4(C)	69.40	63.50	54.80	12.50	7.90	40A	3.75
5(D)	67.00	61.00	52.20	15.30	10.90		

Part Number Code

Series: KP T 2 4 -7W2 M

Terminal type: T = Straight PCB solder

Current rating: 1 = 10A 2 = 20A 3 = 30A 4 = 40A

Contact plating*:
4 = Quality Class 3 (standard)
3 = Quality Class 1

Layout:
5W1 7W2 11W1 9W4 13W3 17W2 21W1
13W6 17W5 25W3 27W2 21W4 25W3 27W2
21W4 24W7 36W4 43W2 47W1

C1 Mounting*:
A1 = A1 No threads B8 = B8 with M3
B1 = B1 with 4-40 UNC C1 = C1 with 4-40 UNC
B2 = B2 with 4-40 UNC C2 = C2 with 4-40 UNC
B3 = B3 with 4-40 UNC C6 = C6 with M3
B6 = B6 with M3 C7 = C7 with M3
B7 = B7 with M3
See mounting drawings below for more details

Insulator color:
B = Black

Shell plating*:
T = Tin (standard) N = Nickel

Gender:
M = Male F = Female

*Contact sales for more details, Konmek have a wide range of alternatives available.

Power D-Sub Mixed Layout KP Series

Straight PCB solder
Mounting

A1

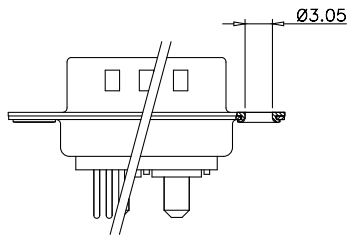

B1/B6

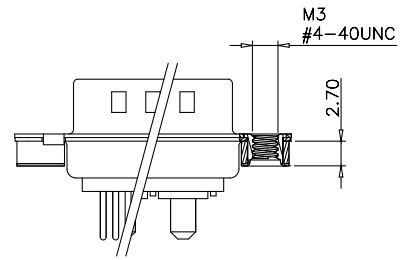

B2/B7

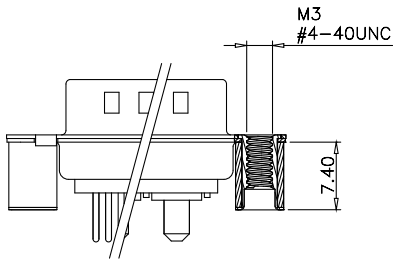

B3/B8

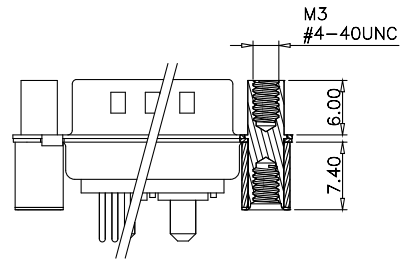

C1/C6

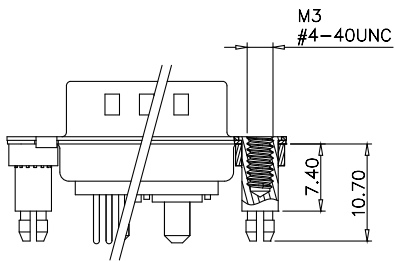

C2/C7

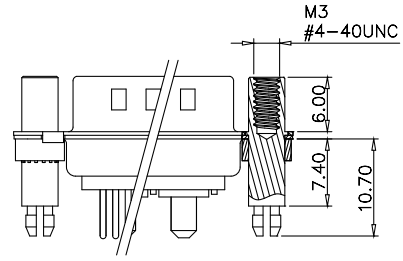

KP

Power D-Sub Mixed Layout KP Series

Straight PCB solder

PCB Layout for Male and Female connector

KP

5W1 Male/Female

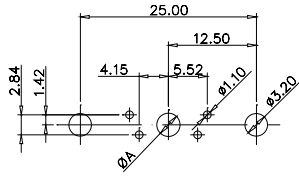

24W7 Male/Female

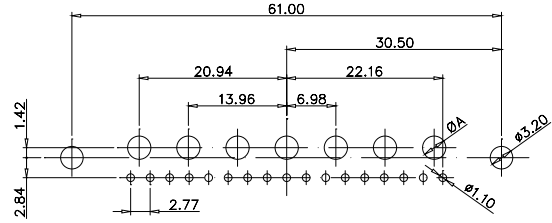

7W2 Male/Female

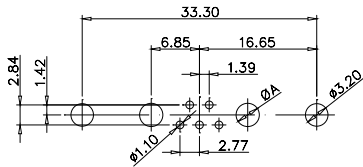

21W4 Male/Female

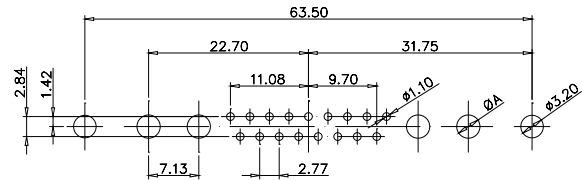

11W1 Male/Female

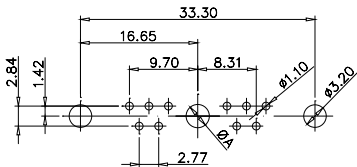

27W2 Male/Female

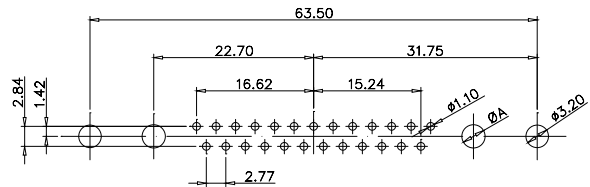

17W2 Male/Female

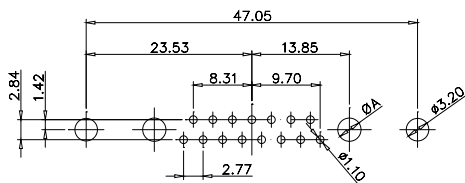

21W1 Male/Female

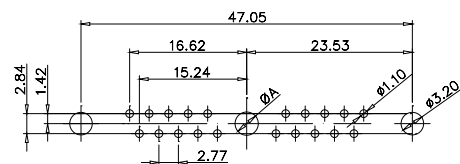

Current Rating	10A	20A	30A	40A
Ø A (mm)	2.2	3.3	3.7	4.2

Power D-Sub Mixed Layout KP Series

Straight PCB solder

PCB Layout for Male connector

KP

9W4 Male

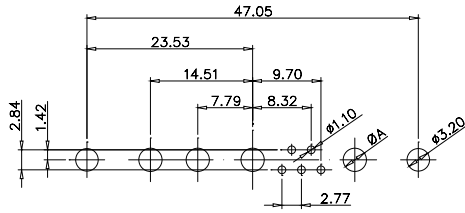

25W3 Male

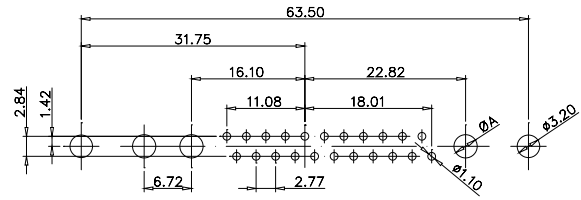

13W3 Male

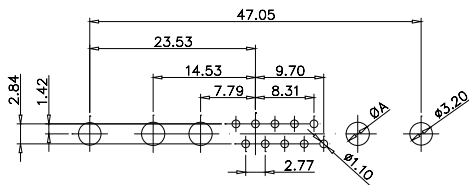

36W4 Male

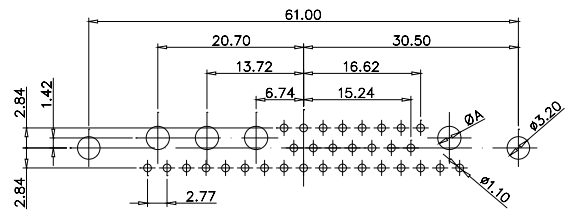

13W6 Male

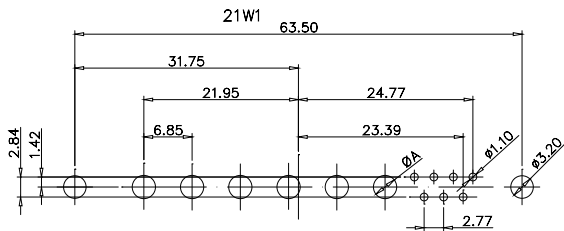

43W2 Male

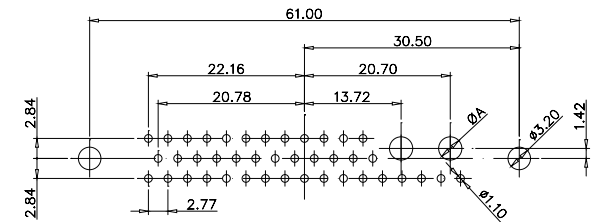

17W5 Male

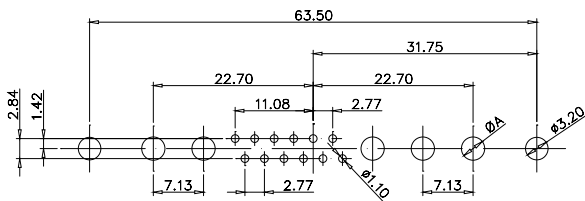

47W1 Male

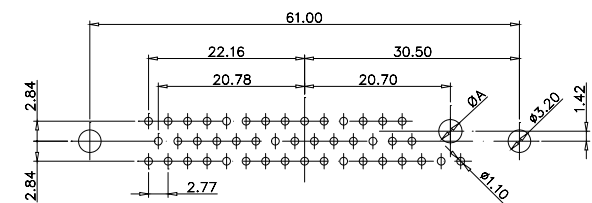

Current Rating	10A	20A	30A	40A
Ø A (mm)	2.2	3.3	3.7	4.2

Power D-Sub Mixed Layout KP Series

Straight PCB solder

PCB Layout for Female connector

KP

9W4 Female

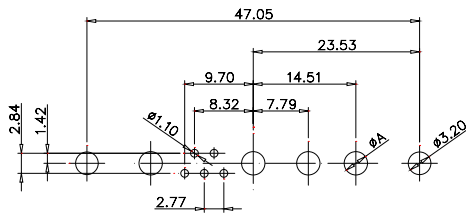

25W3 Female

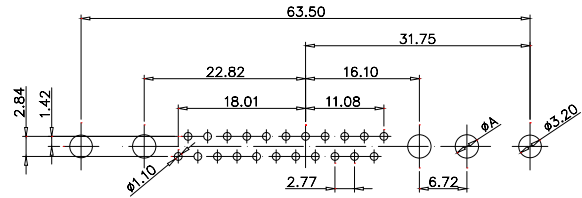

13W3 Female

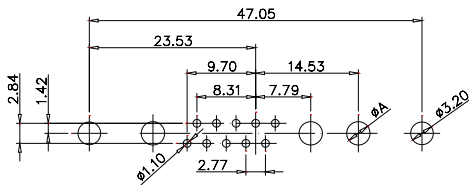

36W4 Female

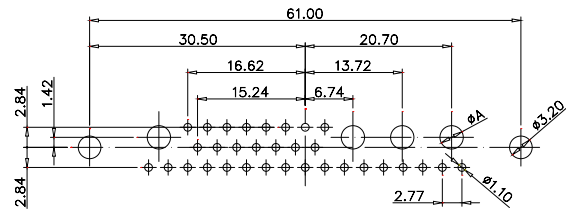

13W6 Female

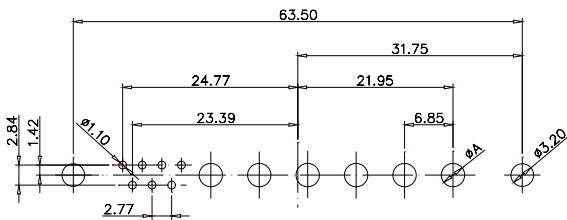

43W2 Female

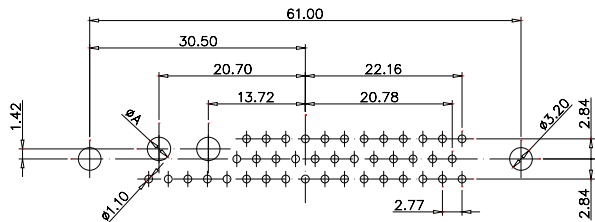

17W5 Female

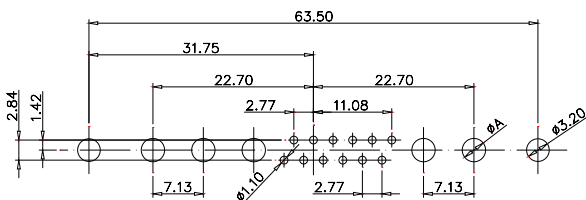

47W1 Female

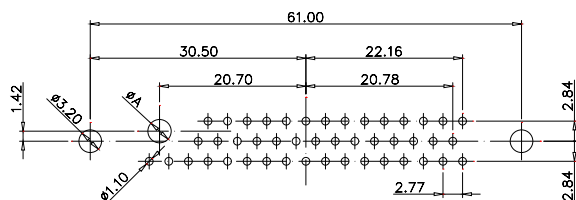

Current Rating	10A	20A	30A	40A
Ø A (mm)	2.2	3.3	3.7	4.2

Power D-Sub Mixed Layout KP Series

R/A PCB solder

Male

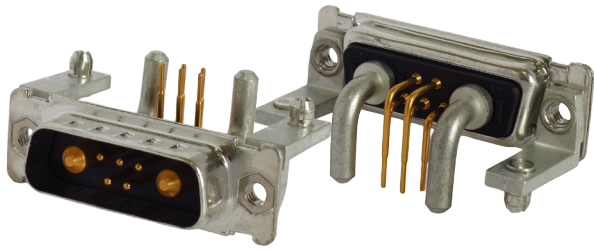

Female

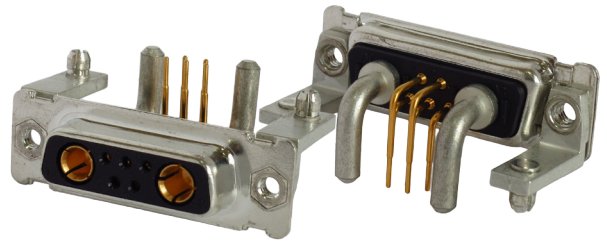

KP

Drawing

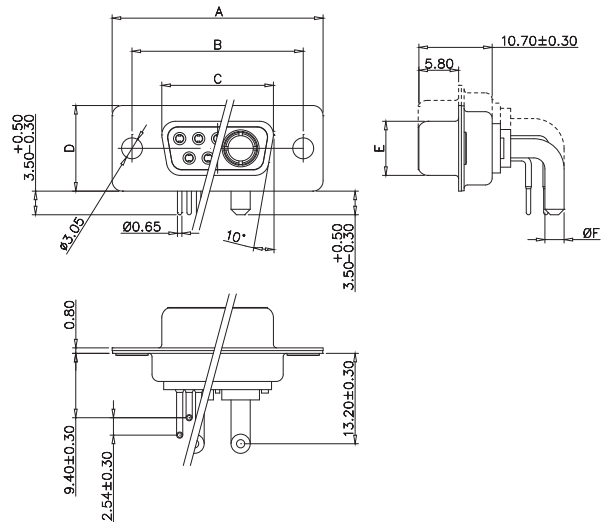
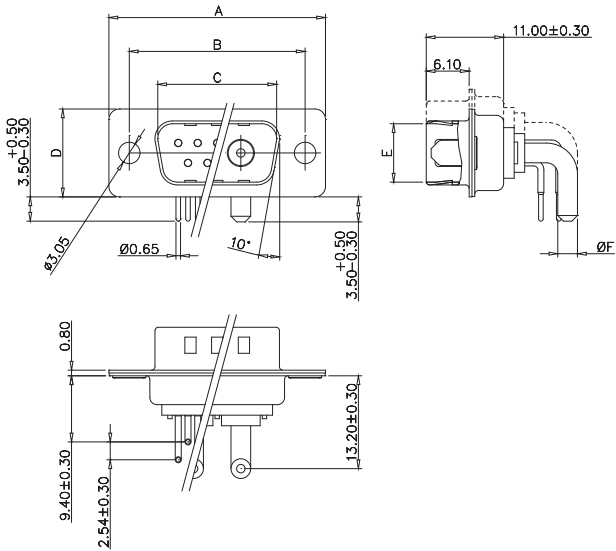

Size	A	B	C	D	E	Rating	Ø F
1(E)	30.80	25.00	16.90	12.50	8.30	10A	1.7
2(A)	39.20	33.30	25.25	12.50	8.30	20A	2.8
3(B)	53.05	47.05	38.95	12.50	8.30	30A	3.2
4(C)	69.40	63.50	55.40	12.50	8.30	40A	3.75
5(D)	67.00	61.00	52.80	15.30	11.15		

Size	A	B	C	D	E	Rating	Ø F
1(E)	30.80	25.00	16.30	12.50	7.90	10A	1.7
2(A)	39.20	33.30	24.60	12.50	7.90	20A	2.8
3(B)	53.05	47.05	38.40	12.50	7.90	30A	3.2
4(C)	69.40	63.50	54.80	12.50	7.90	40A	3.75
5(D)	67.00	61.00	52.20	15.30	10.90		

Part Number Code

Series: KP R 2 4 -7W2 M T B
 KP = Power D-Sub

Terminal type:
 R = R/A PCB solder

Current rating:
 1 = 10A 2 = 20A 3 = 30A 4 = 40A

Contact plating*:
 4 = Quality Class 3 (standard)
 3 = Quality Class 1

Layout:
 5W1 7W2 11W1 9W4 13W3 17W2 21W1
 13W6 17W5 25W3 27W2 21W4 25W3 27W2
 21W4 24W7 36W4 43W2 47W1

D1 Mounting*:
 A1 = A1 No threads D4 = D4 with 4-40 UNC
 B1 = B1 with 4-40 UNC D6 = D6 with M3
 B6 = B6 with M3 D7 = D7 with M3
 D1 = D1 with 4-40 UNC D8 = D8 with M3
 D2 = D2 with 4-40 UNC D9 = D9 with M3
 D3 = D3 with 4-40 UNC
 See mounting drawings below for more details

Insulator color:
 B = Black

Shell plating*:
 T = Tin (standard) N = Nickel

Gender:
 M = Male F = Female

*Contact sales for more details, Konmek have a wide range of alternatives available.

Power D-Sub Mixed Layout KP Series

R/A PCB solder
Mounting

A1

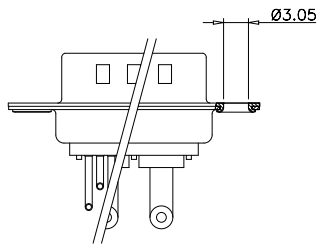

B1/B6

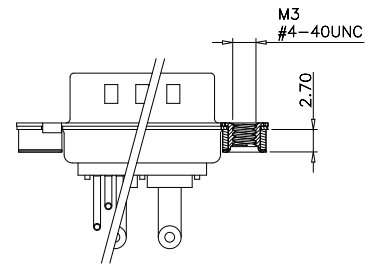

D1/D6

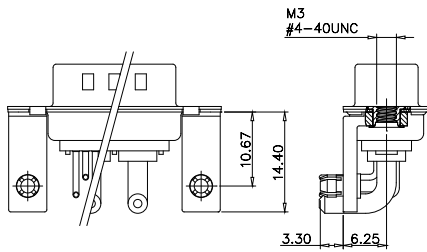

D2/D7

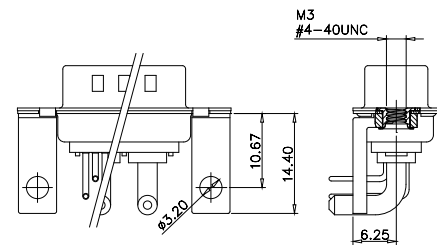

D3/D8

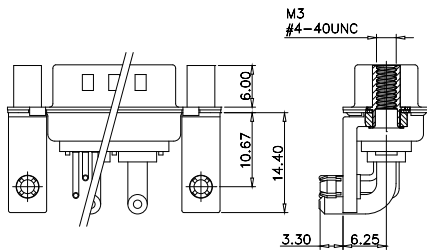

D4/D9

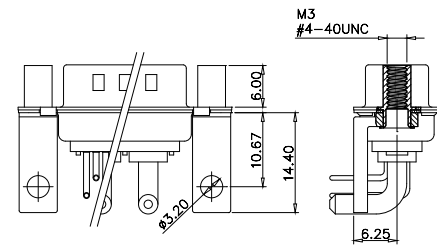

KP

Power D-Sub Mixed Layout KP Series

R/A PCB solder

PCB Layout for Male and Female connector

KP

5W1 Male/Female

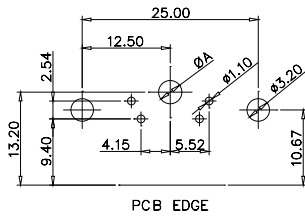

24W7 Male/Female

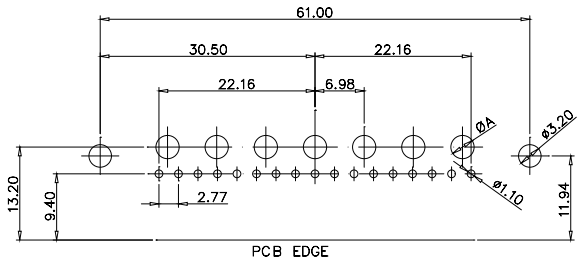

7W2 Male/Female

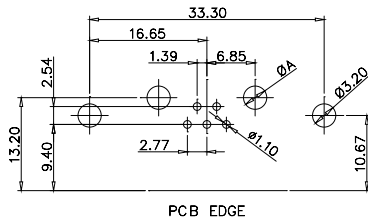

21W4 Male/Female

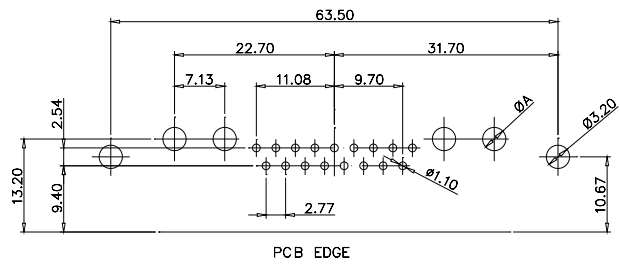

11W1 Male/Female

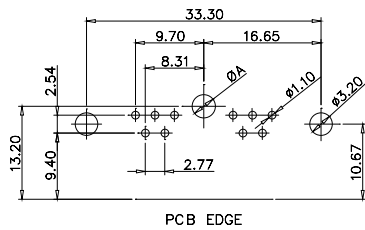

27W2 Male/Female

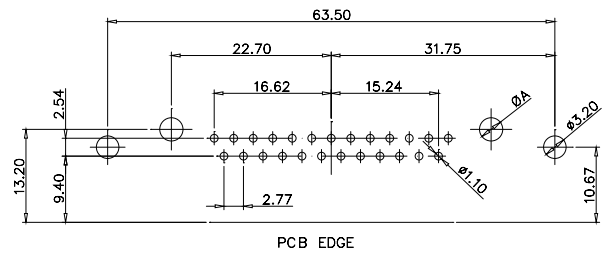

17W2 Male/Female

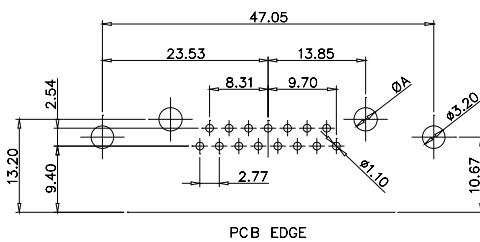

21W1 Male/Female

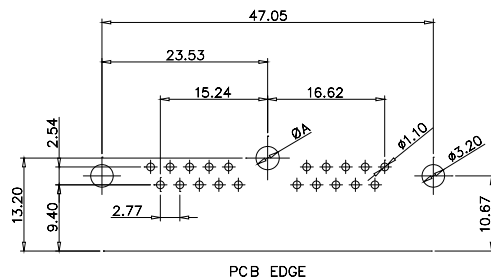

Current Rating	10A	20A	30A	40A
Ø A (mm)	2.2	3.3	3.7	4.2

Power D-Sub Mixed Layout KP Series

R/A PCB solder

PCB Layout for Male connector

KP

9W4 Male

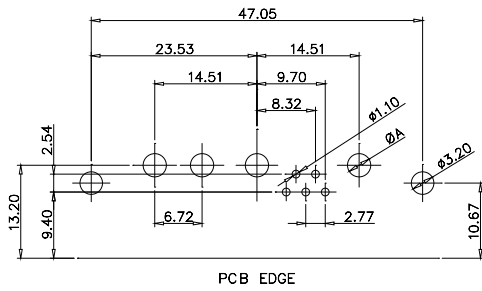

25W3 Male

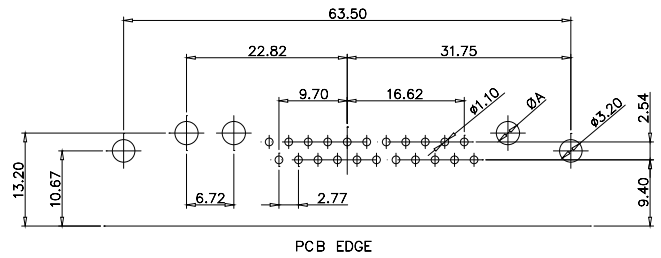

13W3 Male

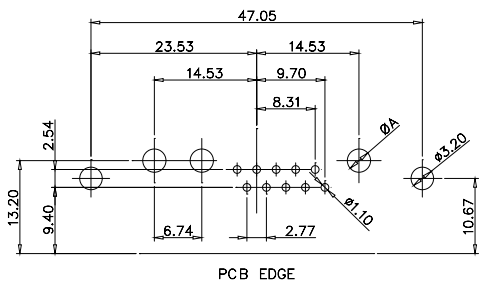

36W4 Male

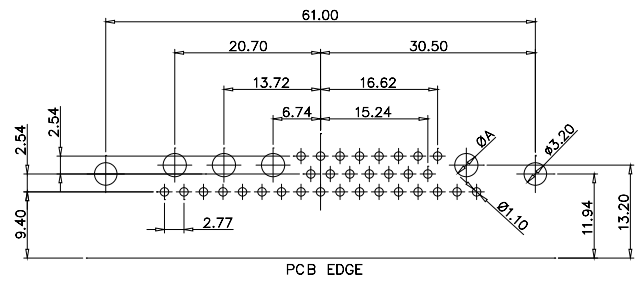

13W6 Male

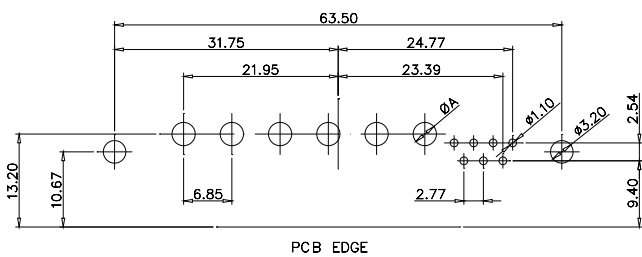

43W2 Male

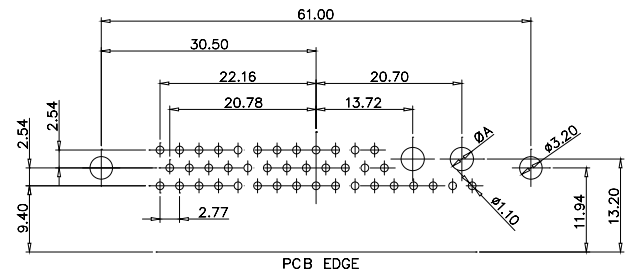

17W5 Male

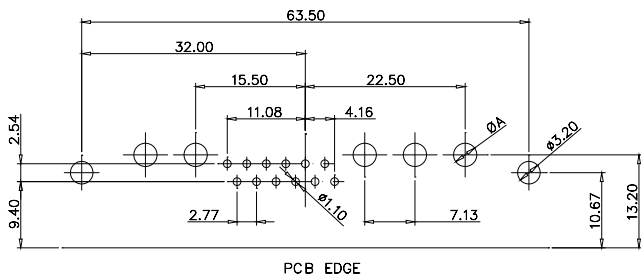

47W1 Male

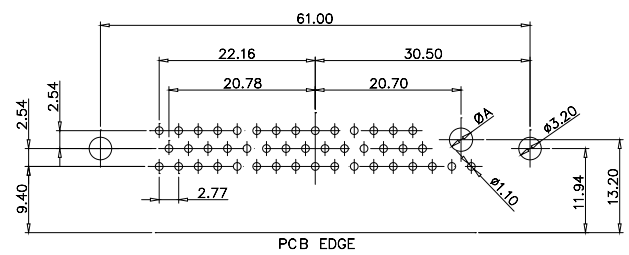

Current Rating	10A	20A	30A	40A
Ø A (mm)	2.2	3.3	3.7	4.2

Power D-Sub Mixed Layout KP Series

R/A PCB solder

PCB Layout for Female connector

KP

9W4 Female

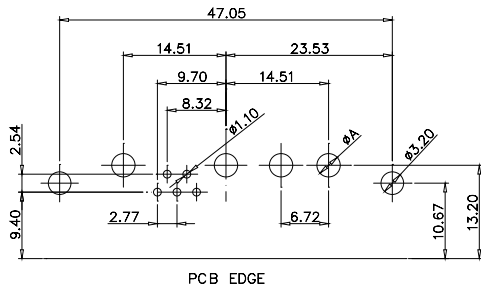

25W3 Female

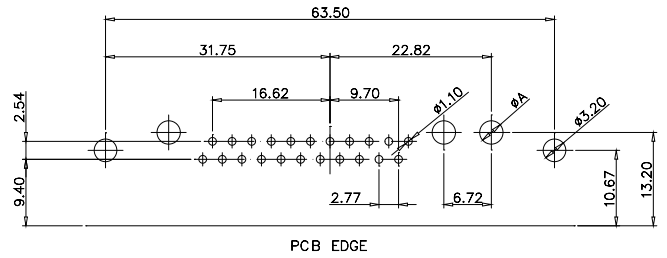

13W3 Female

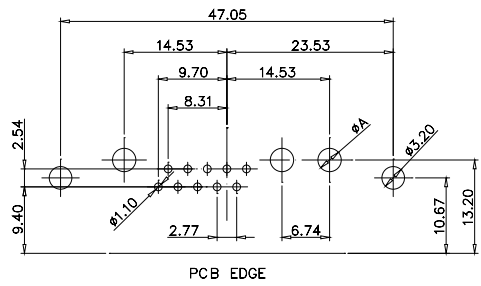

36W4 Female

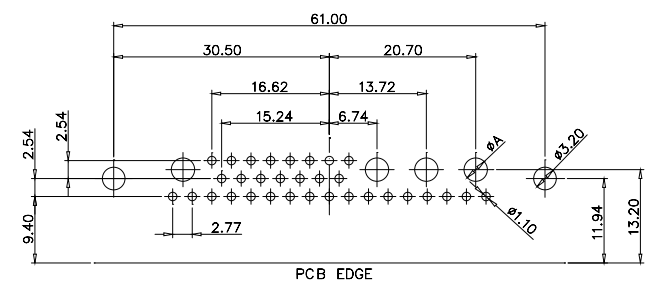

13W6 Female

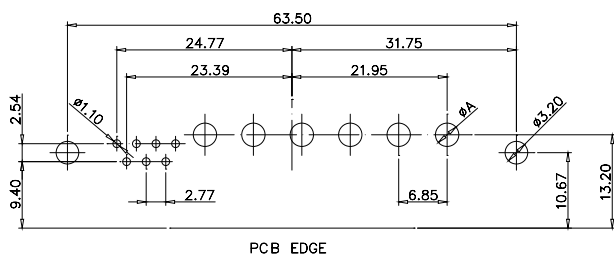

43W2 Female

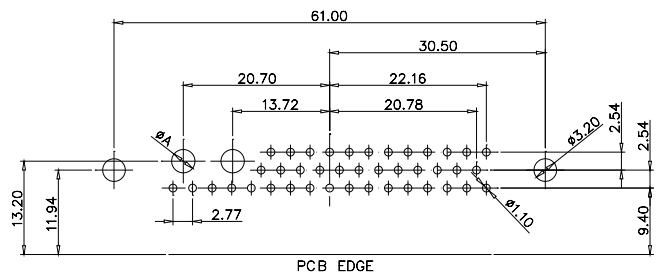

17W5 Female

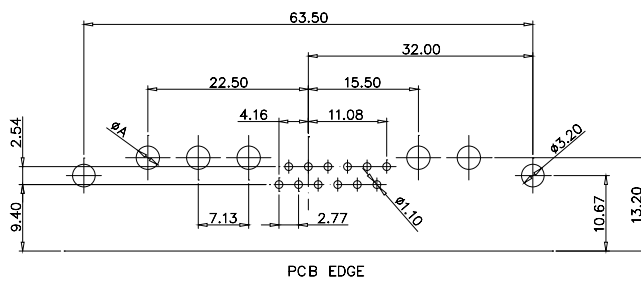

47W1 Female

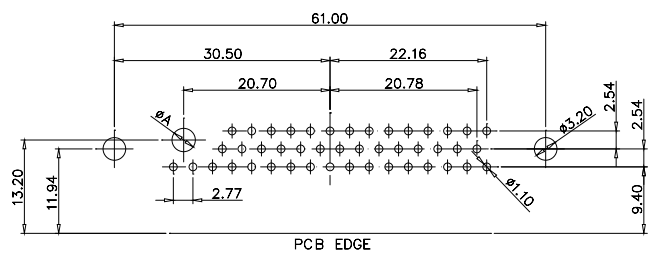

Current Rating	10A	20A	30A	40A
Ø A (mm)	2.2	3.3	3.7	4.2